



SYMON SMITH

RESIDENTIAL & COMMERCIAL ESTATE AGENTS
AND PROPERTY MANAGEMENT

240 Stamford Hill, London, N16 6TT

Sales: 020 8802 0025
sales@symonsmith.co.uk
Management: 020 8802 0022
management@symonsmith.co.uk



Flat 6 London Road, Romford, RM7 9JX

£1,600 PCM

this well-presented two-bedroom flat offers a perfect mix of comfort and convenience. , the property features a spacious reception room, two double bedrooms with built-in wardrobes, and a modern family bathroom.

this flat benefits from gas central heating, a secure entry phone system, and a practical layout.

Ideally situated close to local amenities, transport links, and green spaces, this charming property offers easy access to everything Romford has to offer. Available now – a must-see for tenants seeking a quality home in a great location.

An Ofcom Online search shows that standard, superfast and ultrafast broadband is available. (you may need to organise installation of an FTTP connection in order to achieve ultrafast speeds).

This checker shows the predicted broadband and mobile coverage availability and performance at your address. Please make your own enquiries prior to making an offer.

- Two Bedroom Flat
- Second Floor
- Off Street Parking
- Unfurnished with White Goods
- Havering Council Tax Band C
- Available From 11th June

The Squires, ROMFORD, RM7 9JX

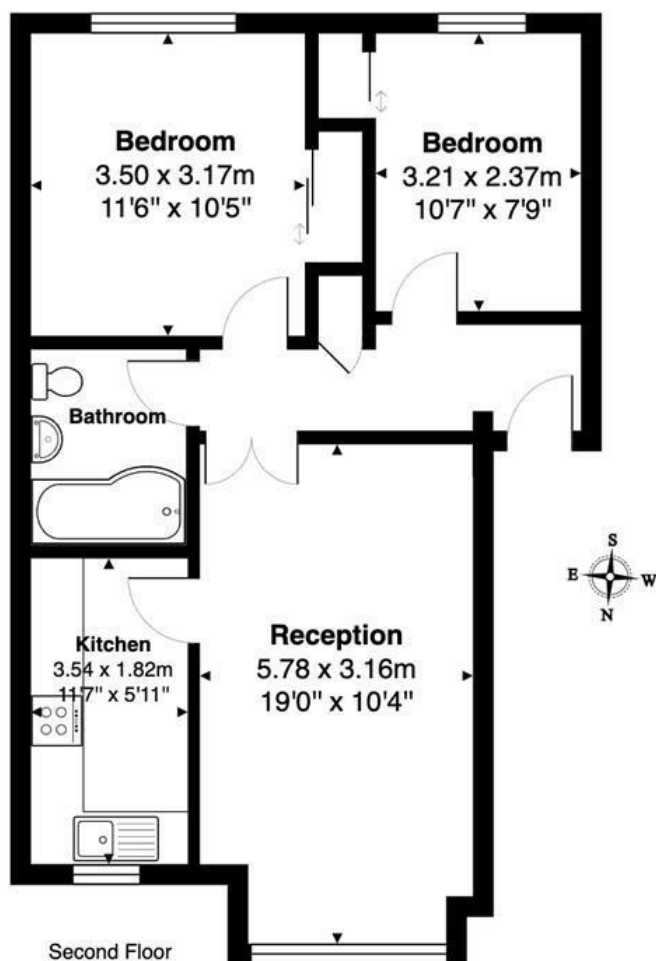

Total Area: 57.2 m² ... 615 ft²

All measurements are approximate and for display purposes only.



WWW.SYMONSMITH.CO.UK